

# BUILDING OUR HOME

# HOPE

FOR ALL >>>>

*Update Fall 2023*



NO



“Enlarge your house;  
build an addition.  
Spread out your home,  
and spare no expense!  
For you will soon be  
bursting at the seams.”

Isaiah 54:2-3 (NLT)

**BUILDING**  
OUR HOME

**HOPE**  
FOR ALL >>>>

HELLO, **FRIEND!**

We're excited to share an update of the progress on the Building Hope adventure.

The Design Team worked diligently over the last several months to prepare excellent construction documents.



### **Building Team**

(left to right) Mark Abram (Team Leader), Brad Allen, Elias Flake (Architect), Dave Jensen, Matt Browning, Brian Hansen, Jeff Abram (not pictured), Mark Sorensen (not pictured), Christa Hansen (not pictured), Chris Townsend (not pictured), Paul Sorensen (not pictured)

Their work has resulted in the design of a beautiful multi-purpose/classroom building that will support Hope's ministry over the years to come for all generations.





Looking north from the new south parking lot



Looking north from the Hope House across the patio



# PRELIMINARY FLOOR PLAN

## MULTIPURPOSE ROOM

The new building will have a large multipurpose room that can be used for many different types of events, and it also can break into three classrooms that can be used for children and youth on Sunday mornings, as well as other activities during the week.

## KITCHEN

A commercial kitchen and serving windows will help support Hope picnics, weddings, and other events on the patio or in the sanctuary.

## PATIO

The building will be enveloped by a large patio area on three sides to enhance community and relationship building before and after events

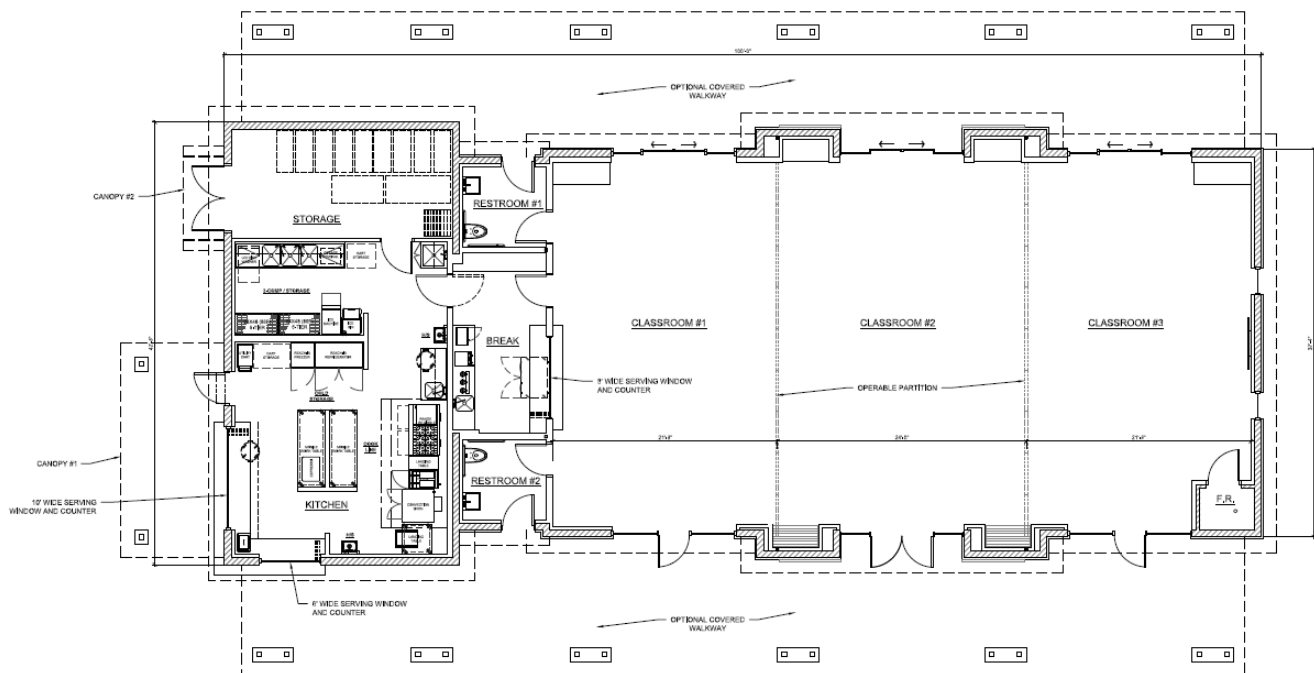

1. PRELIMINARY FLOOR PLAN 

We want to thank you again for your amazing generosity to the Building Hope adventure. So far we have received \$1,270,000 in gifts toward our miracle goal of \$1,500,000. We're getting so close, and we can't wait to see how God brings it all to fruition.

Sincerely grateful,

Pastor Paul & Carol

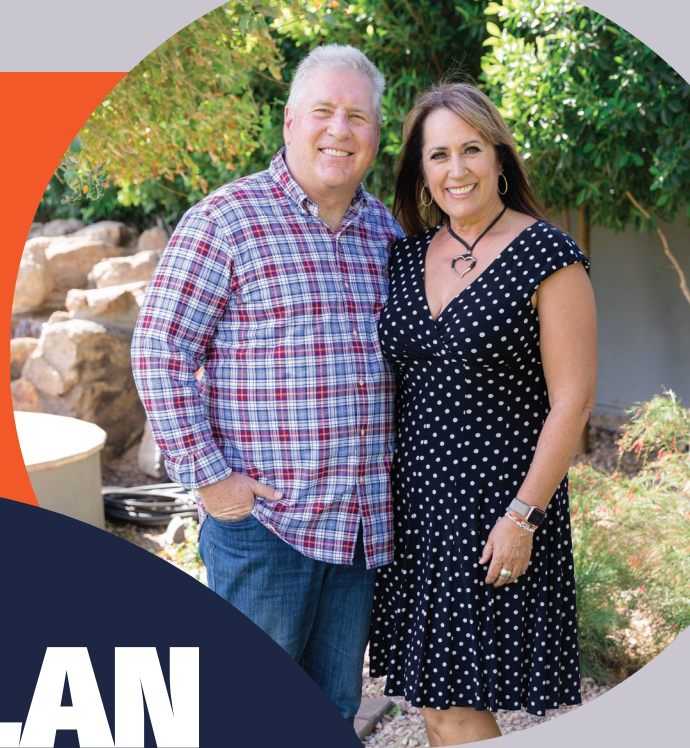

# PHASE I SITE PLAN

The latest site plan for this phase includes paved parking across the entire south end of the property, a larger patio space for picnics and other activities, and more grassy areas for play and gathering.

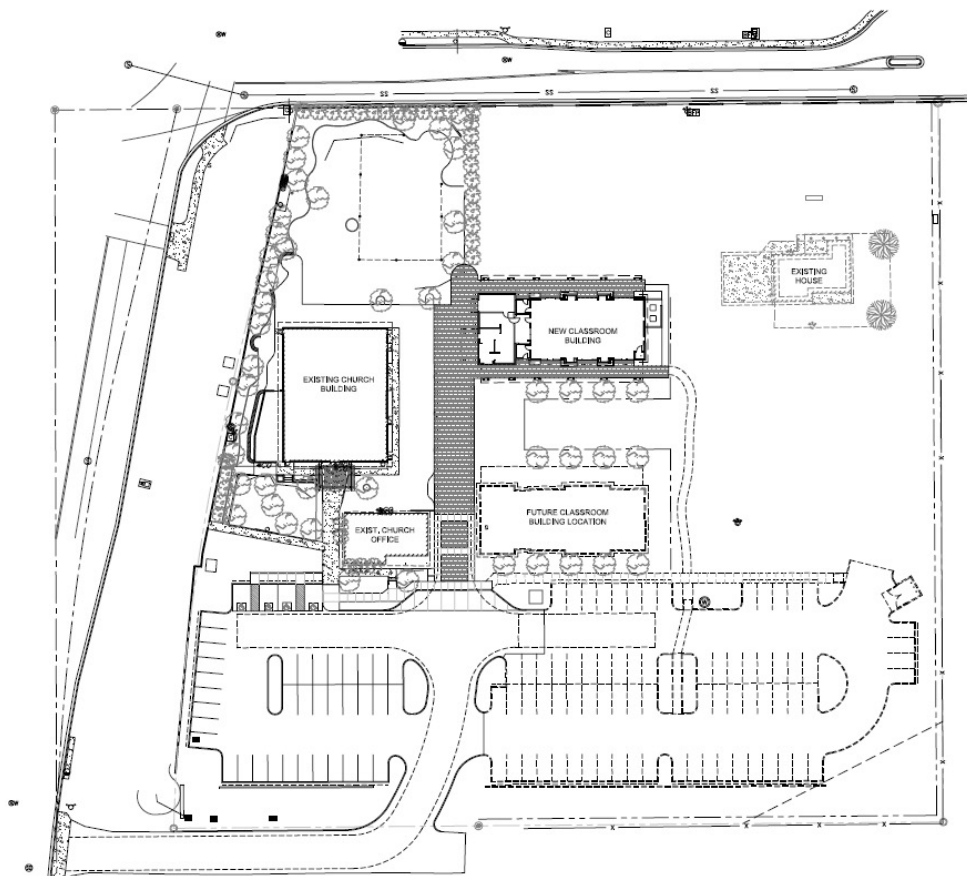

# HOW YOU CAN HELP

## PRAY

You can pray for God's provision as we embark on this exciting journey together.

## GIVE

You can give a one-time gift by donating online to our building fund at: [hopechurch.me/buildinghope](http://hopechurch.me/buildinghope) or mailing a check or cash.

## COMMIT

You can prayerfully consider contributing a set amount each month over two years to expand our property and reach.

